



# User Manual



www.acetek.com

## ❖Specification

- ※ Measures Muzzle Velocity from 30 m/s ~ 400 m/s (90 ft/s ~ 1200 ft/s).
- ※ ROF range: 100~5000RPM
- ※ Extra large caliber (diameter 36mm)
- ※ Tripod Ready mounting hole (Screw for standard camera / camcorder tripods)
- ※ Use AAA battery\*4
- ※ Support Micro-USB(5V/0.5A) power input(no battery charge function)
- ※ Weight: 290g without battery.
- ※ Size : L x W x H = 130 x 108 x 61 (mm).

## ❖Product information

- ◎ AC6000 is an airsoft chronograph with high quality and accuracy
- ◎ User-friendly interface with 128\*128 pixel OLED in white color.
- ◎ Support Micro-USB(5V/0.5A) power input(no battery charge function) or Use AAA battery\*4
- ◎ Ammo parameter setting supports 5 memory slots
- ◎ AMMO 1~5 parameter can be selected on SCR1.
- ◎ 25 memory slots for velocity and ROF (Rate Of Fire)
- ◎ Auto-calculate MAX, MIN, AVG from shot memory slots
- ◎ Idling and low battery auto power off function.
- ◎ Tripod ready mounting hole (standard camera screw / camcorder tripods)
- ◎ Large caliber for 36mm, suitable for different BB Spec. 4.5mm, 6mm, 9mm, 18mm.

## ❖Panel Introduction

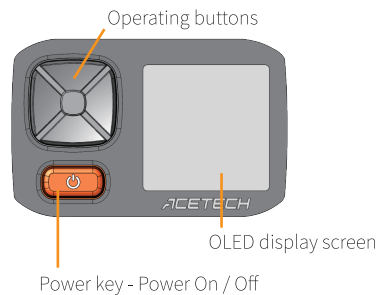

## ❖MENU

◎AMMO : Set BB information

NO	WT	CAL
1	0.2	6
2	0.25	6
>3	0.43	6
4	0.45	6
5	0.88	6

5 memory slots for setting BB weight (WT) & Caliber (CAL)

◎UNIT : Unit Setting

ROF	RPS
SPEED	m/s

※ ROF : Rate Of Fire  
 RPM : Round Per Minute  
 RPS : Round Per Second  
 ※ SPEED : Initial Velocity  
 m/s : Meter per Second  
 ft/s : Feet Per Second

## ❖SCR1 :Screen 1

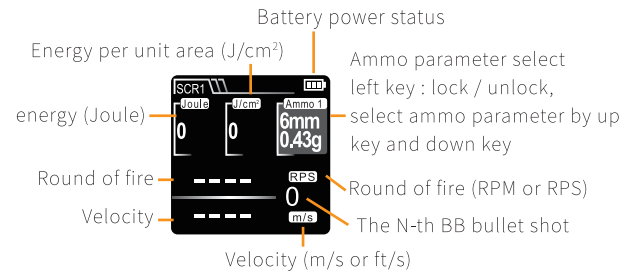

## ❖SCR2 :Screen 2

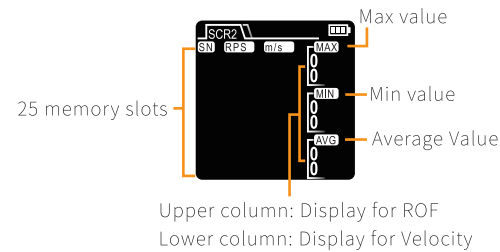

◎APO : Auto Power Off

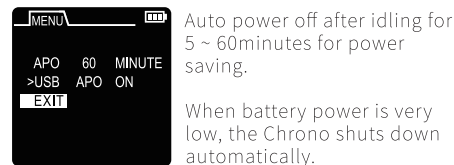

◎CONTRAST : OLED contrast

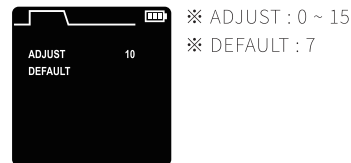

◎RESET : Factory Default



## ❖Each part of description

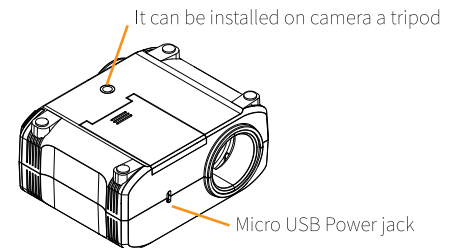
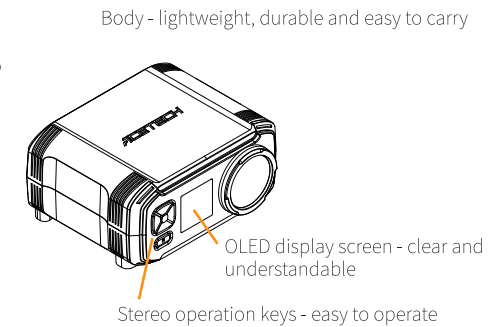

## ❖Battery Description

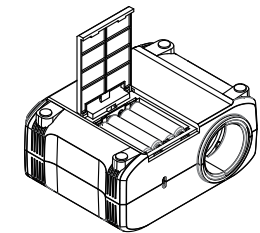

1. Push out the battery cover.
2. Put in 4 AAA batteries.
3. Close the battery cover.
4. Do Not install the used and new batteries at the same time for better device performance, safety and stability.
5. When device is not used for a longer period, please take out the batteries to prevent device malfunction from battery leakage.

\*All the specifications and contents in this manual are subject to change without notice.

\*All the specifications and contents are only for reference, please make the object as the standard.