

# WARNING: BEFORE USAGE, THE INSTRUCTION MUSE BE READ.

THANK YOU FOR PURCHASING. THE FOLLOWING ATTENTION POINTS AND INSTRUCTIONS MUST BE READ. SHOOTING WITHOUT CAUTION OR USED IMPROPERLY, BLINDNESS OR INJURIES COULD BE LEAD.

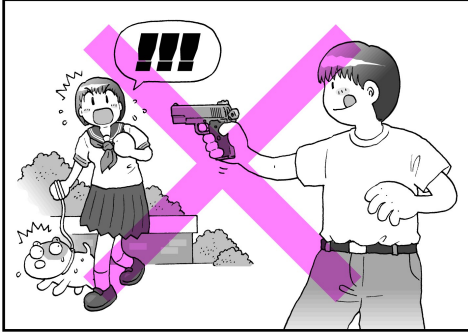

DO NOT POINT AT PEOPLE OR ANIMAL.



GUN AND GAS MUST NOT BE PLACED IN AREA WHERE TEMPERATURE IS OVER 40 °C

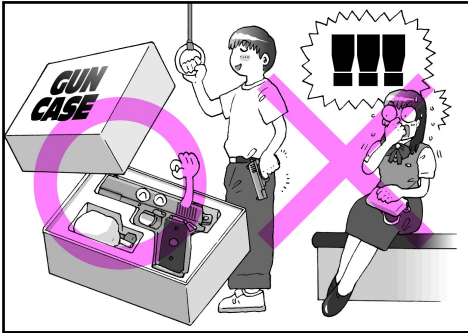

PLACE IN GUN CASE WHEN NOT IN USING OR TRANSPORTING



DO NOT USE GAS WHICH PRESSURE IS OVER 12 Kgs/cm<sup>2</sup>

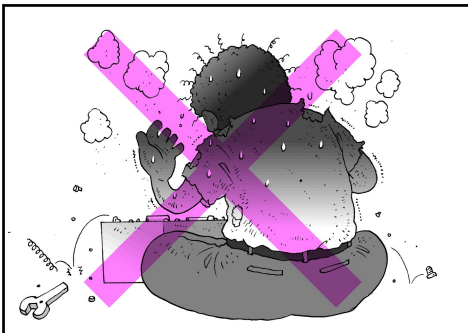

UNAUTHORIZED RECONSTRUCTION OF AIR SOFT GUN TO STRENGTHEN FIRING FUNCTION IS STRICTLY PROHIBITED.

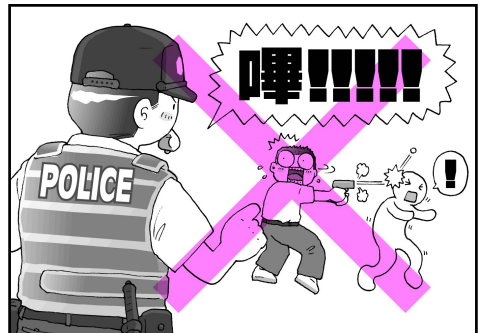

BE CAREFULL WHAT TARGET YOU SHOOT

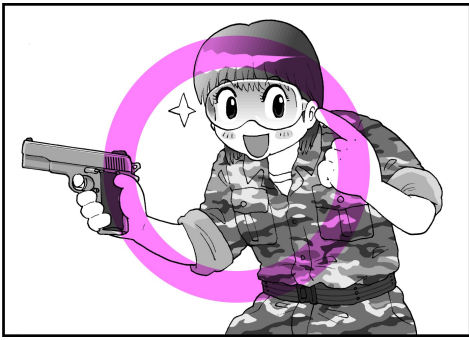

EYE PROTECTION DEVICE MUST BE EQUIPPED



DO NOT LOAD ANYTHING BUT BB BULLETS.

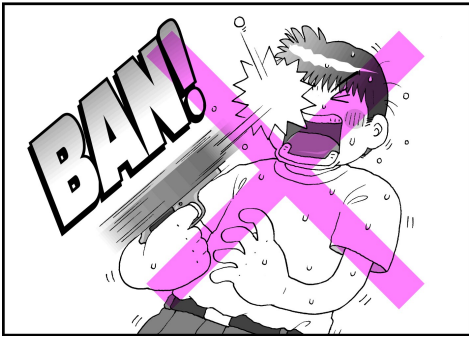

DO NOT LOOK THROUGH THE BARREL



PLEASE SHOOT IN SAFE PLACE

## OPERATION

### 1. REMOVE THE MAGAZINE

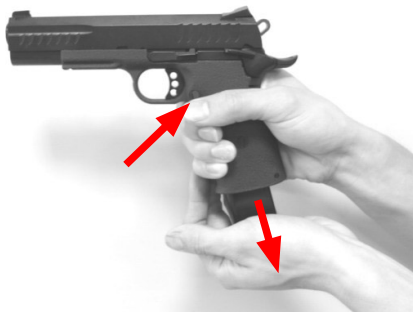

PRESS MAGAZINE CATCH AND REMOVE MAGAZINE

### 2. FILLING GAS

GAS MAG

CO2 MAG

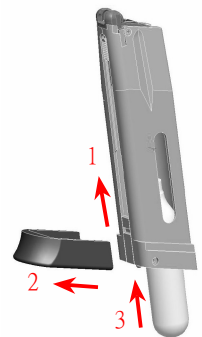
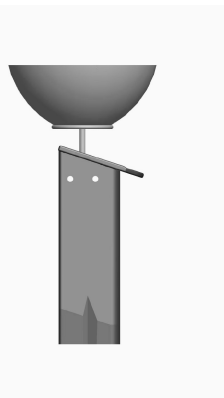

GAS MAG:

FILL THE GAS BOTTLE TO THE MAGAZINE IN VERTICAL DIRECTOR.

CO2 MAG:

Follow the instruction to insert the cartridge

### 3.LOAD BB BULLETS



LOAD BULLETS

### 4.INSERT MAGAZINE



### 5.LOAD



PULL THE SLIDE COMPLETELY TO THE REAR.

### 6.FIRE



PULL THE TRIGGER.

### 7.SAFETY

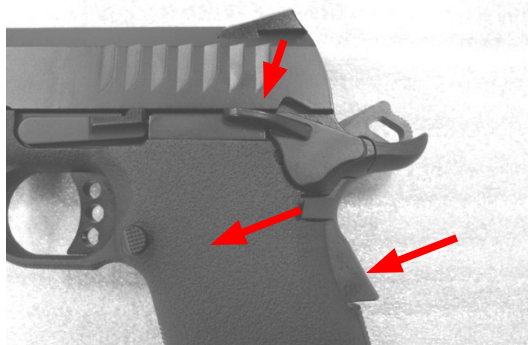

SAFETY OFF(READY FOR FIRE)

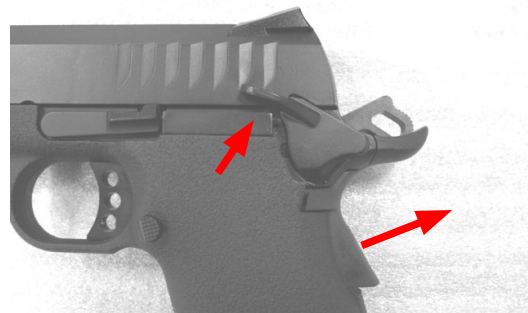

SAFETY ON

# DISASSEMBLY

1. REMOVE THE SLIDE STOP

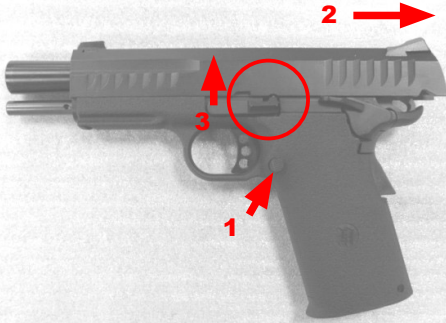

PRESS MAGAZINE CATCH AND REMOVE MAGAZINE. MOVE THE SLIDE REAR UNTIL THE TAKEDOWN NOTCH IS JUST ABOVE THE SLIDE STOP TAB AND REMOVE SLIDE STOP

2. REMOVE THE SLIDE



3. REMOVE THE RECOIL SPRING AND SPRING CAP

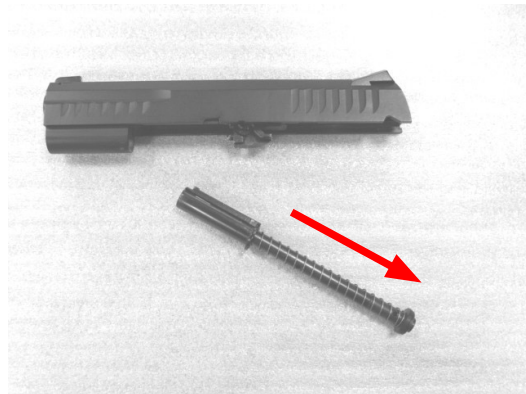

4. REMOVE THE BARREL

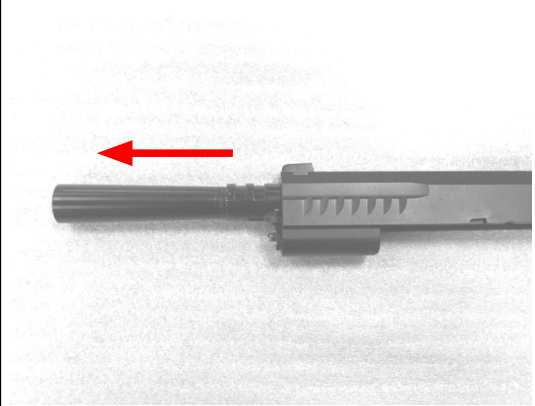

# ASSEMBLY

REVERSE THE DISASSEMBLY ORDER

ADJUST TREJECTORY

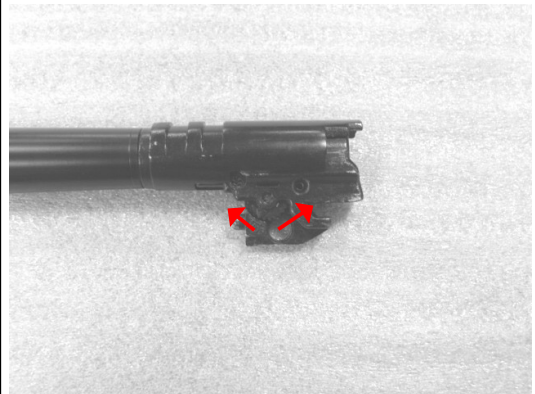

TWIST THE ADJUST DIAL TO ADJUST TEAJECTORY.

PLEASE ADJUST ACCORDING TO TREJECTORT

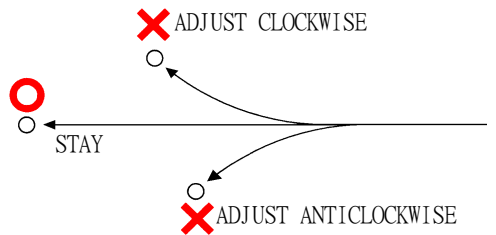

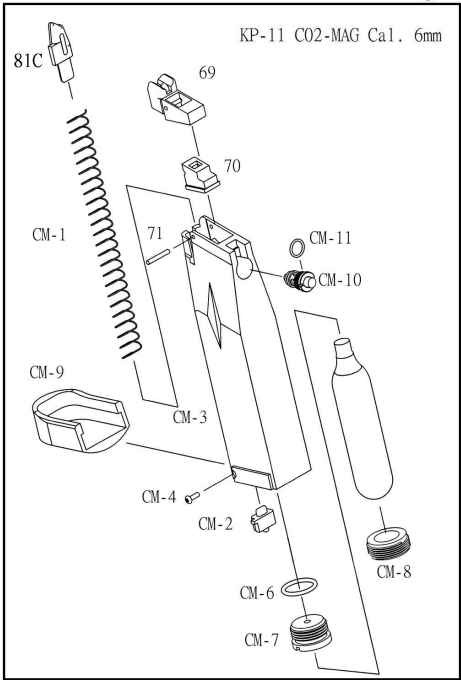
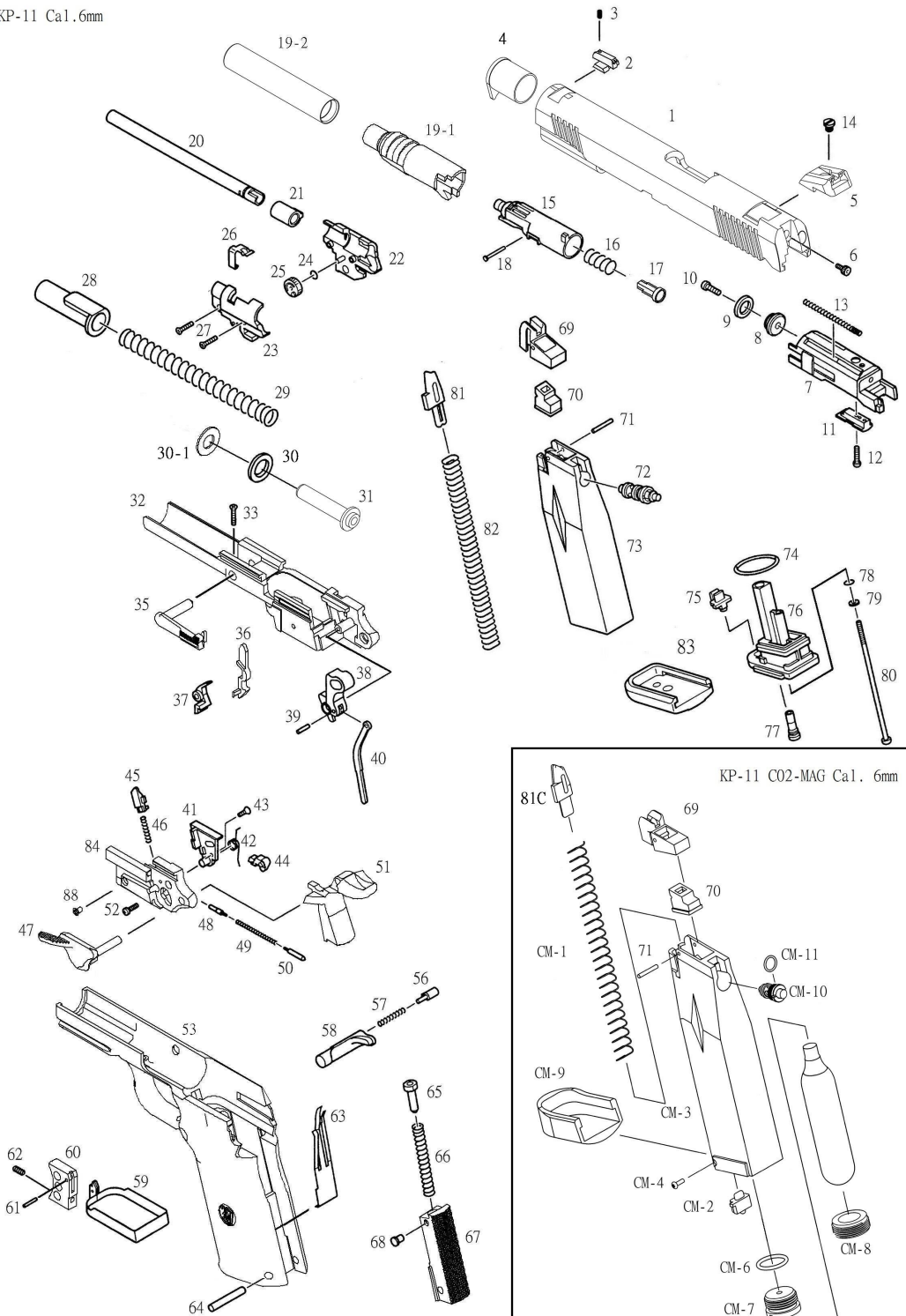

No.	Name of Part	Price	No.	Name of Part	Price
1	Slide	1600	50	Safety Plunger	50
2	Front Sight	120	51	Grip Safety	240
3	Front Sight Screw	10	52	Chassis Cover Screw	10
4	Barrel Bush	120	53	Grip	800
5	Rear Sight	150	56	Magazine Catch Lock	30
6	Pinton Screw	20	57	Magazine Catch Spring	10
7	Piston	400	58	Magazine Catch	120
8	Ring Head	40	59	Trigger Bar	150
9	Ring	20	60	Trigger	240
10	Ring Head Screw	10	61	Trigger Pin	10
11	Piston Part	30	62	Trigger adjust Screw	20
12	Piston Part Screw	10	63	Sear Spring	100
13	Cylinder Return Spring	20	64	Housing Pin	50
14	Rear Sight Screw	20	65	Hammer Spring Plunger	30
15	Cylinder	150	66	Hammer Spring	70
16	Cylinder Valve Spring	20	67	Hammer Spring Housing	120
17	Cylinder Valve	20	68	Plunger Stopper	40
18	Cylinder Valve Stopper	20	69	BB Lip Pin	60
19-1	Outter Barrel Part-1	300	70	Magazine Gasket	80
19-2	Outter Barrel Part-2	300	71	BB Lip Pin	10
20	Inner Barrel	180	72	Valve	150
21	Rubber Chamber	80	73	Magazine Case	400
22	Chamber Cover (Right)	140	74	O-Ring	20
23	Chamber Cover (Left)	140	75	Magazine spring Retainer	20
24	O-Ring	10	76	Magazine Base	180
25	Adjust Dial	20	77	Filling Valve	70
26	Adjust Lever	50	78	O-Ring	10
27	Chamber Cover Screw	10	79	Washer	10
28	Recoil Plug	200	80	Magazine Base Screw	20
29	Recoil Spring	60	81	Follower(Gas)	30
30	Recoil Spring Guide Buffer	30	81C	Follower(Co2)	30
30-1	Washer	20	82	Follower Spring	50
31	Recoil Spring Guide B	150	83	Magazine Bottom	120
32	Chassis	600	84	Chassis Cover	200
33	Chassis Screw	10	88	Chassis Cover Screw	10
35	Slide Stop	200	CM-1	FOLLOWER LEVER SPRING	50
36	Disconnecter	150	CM-2	FOLLOWER SPRING RETAINER	30
37	Sear	120	CM-3	MAGAZINE CASE	400
38	Hammer	300	CM-4	SPRING RATAINER SCREW	10
39	Hammer Pin	10	CM-6	CARTRIDGE STAB O RING	20
40	Hammer Strut	50	CM-7	CARTRIDGE STAB	180
41	Chassis Cover Part	80	CM-8	CARTRIDGE BOTTOM CAP	100
42	Knocker Spring	30	CM-9	MAGAZINE BOTTOM CAP	120
43	Chassis Cover Part Screw	10	CM-10	VALVE	200
44	Knocker	100	CM-11	VALVE O RING	20
45	Knocker Lock	100			
46	Knocker Lock Spring	20			
47	Safety (Left)	150			
48	Slide Stop Plunger	50			
49	Slide Stop Plunger Spring	15			

**KP-11**  
**MANUAL**

# **KJWORKS**

**[kjworks.com.tw](http://kjworks.com.tw)**